

Euro standard for flanges

The current DIN standards for flanges have been replaced by the new Euro standard: EN1092-1. One and the same EN standard now applies to all flanges. To indicate the difference between the various flange shapes, such as welding flanges and flat welding flanges, the EN10921 uses various “type” designations. See the table below.

Definition:	Old DIN standard	New EN standard	Type	Pressure
Welding flange	2631	EN1092-1	11	PN6
Welding flange	2632	EN1092-1	11	PN10
Welding flange	2633	EN1092-1	11	PN16
Welding flange	2634	EN1092-1	11	PN25
Welding flange	2635	EN1092-1	11	PN40
Welding flange	2636	EN1092-1	11	PN63
Welding flange	2637	EN1092-1	11	PN100
Flat welding flange	2573	EN1092-1	1	PN6
Flat welding flange	2576	EN1092-1	1	PN10 up/incl 100
Transfer flange	2642	EN1092-1	2	PN10 up/incl 40
Blind flange	2527	EN1092-1	5	PN6 up/incl100
Threaded flange	2566	EN1092-1	13	PN10 up/incl 100
Transfer flange with collar	86030	EN1092-1	12	PN10up/incl 100

If desired, flanges can be supplied with certificate EN10204/3.1.

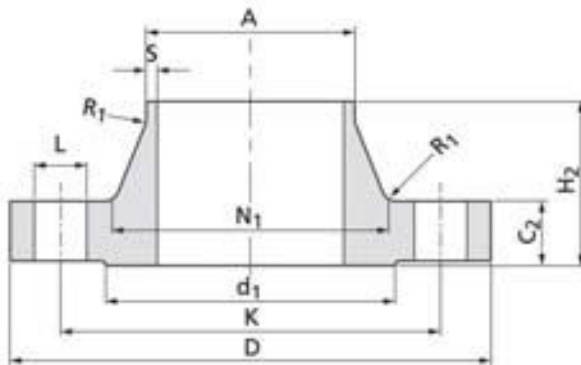

D1 mm	S1 mm	Pressure	Surface	Type	Norm	Surface	Quality	kg/pc
76,1	2.9	16	Form D		DIN 2633/ EN1092-1(11)	Bl Unoil	C22.8/P250GH	3,06

Steel and stainless steel

Flanges

Threaded steel C22.8, according to DIN standard 2566 New EN 1092-1(13)
 Welded welds steel C22.8 according to DIN standard 2633 (2631 / 2635) New EN 1092-1(11) Flat welding welds steel 37.2 according to DIN standard 2576 New EN 1092-1(1)
 Blind flanges steel 37, according to DIN standard 2527 New EN 1092-1(5)

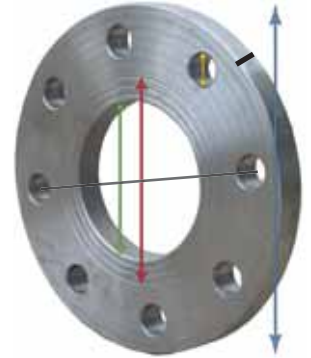
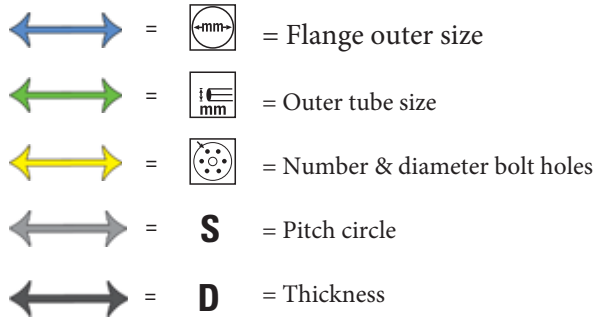

Top quality for a wide range of applications within the chemical and petrochemical industry, offshore, etc. In addition to this range of most commonly used flanges, a large number of types and sizes are available on request.



THREAD FLANGES STEEL DIN 2566 /EN 1092-1(13) ST37 GALVANIZED - 16 BAR -

FLEN		S	D	BSPP	-mm-	i mm	
DN15-TF16B-12	FLANGE-THR- 2566-16-1/2"	65	14	1/2"	95	21,3	4X14 mm
DN20-TF16B-34	FLANGE-THR-2566-16-3/4"	75	16	3/4"	105	26,9	4X14 mm
DN25-TF16B-1	FLANGE-THR-2566-16-1"	85	16	1"	115	33,7	4X14 mm
DN32-TF16B-114	FLANGE-THR-2566-16-1.1/4"	100	16	1.1/4"	140	42,4	4X18 mm
DN40-TF16B-112	FLANGE-THR-2566-16-1.1/2"	110	16	1.1/2"	150	48,3	4X18 mm
DN50-TF16B-2	FLANGE-THR-2566-16-2"	125	18	2"	165	60,3	4X18 mm
DN65-TF16B-212	FLANGE-THR-2566-16-2.1/2"	145	18	2.1/2"	185	76,1	4X18 mm
DN80-TF16B-3	FLANGE-THR-2566-16-3"	160	20	3"	200	88,9	8X18 mm
DN100-TF16B-4	FLANGE-THR-2566-16-4"	180	20	4"	220	114,3	8X18 mm



THREAD FLANGES STEEL DIN 2566/EN 1092-1(13) ST37 BLACK - 16 BAR -

FLEN		S	D	BSPP	-mm-	i mm	
DN15-TF16B-12Z	FLANGE-THR-2566-16-1/2"Z	65	14	1/2"	95	21,3	4X14 mm
DN20-TF16B-34Z	FLANGE-THR-2566-16-3/4"Z	75	16	3/4"	105	26,9	4X14 mm
DN25-TF16B-1Z	FLANGE-THR-2566-16-1"Z	85	16	1"	115	33,7	4X14 mm
DN32-TF16B-114Z	FLANG-THR-2566-16-1.1/4"Z	100	16	1.1/4"	140	42,4	4X18 mm
DN40-TF16B-112Z	FLANGE-THR-2566-16-1.1/2"Z	110	16	1.1/2"	150	48,3	4X18 mm
DN50-TF16B-2Z	FLANGE-THR-2566-16-2"Z	125	18	2"	165	60,3	4X18 mm
DN65-TF16B-212Z	FLANGE-THR-2566-16-2.1/2"Z	145	18	2.1/2"	185	76,1	4X18 mm
DN80-TF16B-3Z	FLANGE-THR-2566-16-3"Z	160	20	3"	200	88,9	8X18 mm
DN100-TF16B-4Z	FLANGE-THR-2566-16-4"Z	180	20	4"	220	114,3	8X18 mm

Steel and stainless steel

Flanges

WELDING FLANGES STEEL DIN 2633 / EN1092-1(11) C22,8 - 16 BAR



FLEN			S	D	mm	mm	
DN015-WFL021-16	Welding	flanges-2633-015-021-16	65	14	95	21,3	4X14 mm
DN020-WFL026-16	Welding	flanges-2633-020-026-16	75	16	105	26,9	4X14 mm
DN025-WFL033-16	Welding	flanges-2633-025-033-16	85	16	115	33,7	4X14 mm
DN032-WFL042-16	Welding	flanges-2633-032-042-16	100	16	140	42,4	4X18 mm
DN040-WFL048-16	Welding	flanges-2633-040-048-16	110	16	150	48,3	4X18 mm
DN050-WFL060-16	Welding	flanges-2633-050-060-16	125	18	165	60,3	4X18 mm
DN065-WFL076-16	Welding	flanges-2633-065-076-16	145	18	185	76,1	4X18 mm
DN080-WFL088-16	Welding	flanges-2633-080-088-16	160	20	200	88,9	8X18 mm
DN100-WFL114-16	Welding	flanges-2633-100-114-16	180	20	220	114,3	8X18 mm
DN125-WFL139-16	Welding	flanges-2633-125-139-16	210	22	250	139,7	8X18 mm
DN150-WFL168-16	Welding	flanges-2633-150-168-16	240	22	285	168,3	8X22 mm
DN200-WFL219-16	Welding	flanges-2633-200-219-16	295	24	340	219,1	12X22 mm

Weld-on flanges in PN6 (DIN2631), PN10 (DIN2632) and PN40 (DIN2635) and in other sizes are available on request

FLAT WELDING FLANGES STEEL DIN 2576/ EN1092-1(1) ST37,2



FLEN		S	D	bar	mm	mm	
DN015-PFL021-16	Flange-pl-2576-015-021-16	65	14	16	95	21,3	4x14 mm
DN020-PFL026-16	Flange-pl-2576-020-026-16	75	16	16	105	26,9	4x14 mm
DN025-PFL033-16	Flange-pl-2576-025-033-16	85	16	16	115	33,7	4x14 mm
DN032-PFL042-16	Flange-pl-2576-032-042-16	100	16	16	140	42,4	4x18 mm
DN040-PFL048-16	Flange-pl-2576-040-048-16	110	16	16	150	48,3	4x18 mm
DN050-PFL060-16	Flange-pl-2576-050-060-16	125	18	16	165	60,3	4x18 mm
DN065-PFL076-16	Flange-pl-2576-065-076-16	145	18	16	185	76,1	4x18 mm
DN080-PFL088-10	Flange-pl-2576-080-088-10	160	20	10	200	88,9	4x18 mm
DN080-PFL088-16	Flange-pl-2576-080-088-16	160	20	16	200	88,9	8x18 mm
DN100-PFL114-16	Flange-pl-2576-100-114-16	180	20	16	220	114,3	8x18 mm
DN125-PFL139-16	Flange-pl-2576-125-139-16	210	22	16	250	139,7	8x18 mm
DN150-PFL168-16	Flange-pl-2576-150-168-16	240	22	16	285	168,3	8x22 mm
DN200-PFL219-10	Flange-pl-2576-200-219-10	295	24	10	340	219,1	8x22 mm
DN200-PFL219-16	Flange-pl-2576-200-219-16	295	24	16	340	219,1	12x22 mm
DN250-PFL273-10	Flange-pl-2576-250-273-10	350	26	10	395	273,0	12x22 mm
DN300-PFL323-10	Flange-pl-2576-300-323-10	400	26	10	445	323,9	12x22 mm
DN350-PFL355-10	Flange-pl-2576-350-355-10	460	28	10	505	355,6	16x22 mm
DN400-PFL406-10	Flange-pl-2576-400-406-10	515	32	10	565	406,4	16x26 mm
DN450-PFL457-10	Flange-pl-2576-450-457-10	565	26	10	615	457,0	20x27 mm
DN500-PFL508-10	Flange-pl-2576-500-508-10	620	26	10	670	508,0	20x27 mm

Flat welding flanges in PN6 (DIN2573) / EN1092-1(1) and in other sizes are available on request

BLIND FLANGES STEEL DIN 2527 / EN1092-1(5) ST37 -16 BAR -



FLEN		S	D	bar	mm	
DN015-BF-16	Flange-Blind-2527-015-16	65	14	16	95	4X14 mm
DN020-BF-16	Flange-Blind-2527-020-16	75	16	16	105	4X14 mm
DN025-BF-16	Flange-Blind-2527-025-16	85	16	16	115	4X14 mm
DN032-BF-16	Flange-Blind-2527-032-16	100	16	16	140	4X18 mm
DN040-BF-16	Flange-Blind-2527-040-16	110	16	16	150	4X18 mm
DN050-BF-16	Flange-Blind-2527-050-16	125	18	16	165	4X18 mm
DN065-BF-16	Flange-Blind-2527-065-16	145	18	16	185	4X18 mm
DN080-BF-16	Flange-Blind-2527-080-16	160	20	16	200	8X18 mm
DN100-BF-16	Flange-Blind-2527-100-16	180	20	16	220	8X18 mm
DN125-BF-16	Flange-Blind-2527-125-16	210	22	16	250	8X18 mm
DN150-BF-16	Flange-Blind-2527-150-16	240	22	16	285	8X22 mm

Steel and stainless steel

Flanges



BLIND FLANGES STEEL DIN 2527 / EN1092-1(5) ST37 - 10 BAR -

FLEN			S	D	10 bar	mm	
DN080-BF-10	Flange-Blind-2527-080-10		160	20	10	200	4X18 mm
DN200-BF-10	Flange-Blind-2527-200-10		295	24	10	340	8X22 mm
DN250-BF-10	Flange-Blind-2527-250-10		350	26	10	395	12X22 mm
DN300-BF-10	Flange-Blind-2527-300-10		400	26	10	445	12X22 mm
DN350-BF-10	Flange-Blind-2527-350-10		460	26	10	505	16X22 mm
DN400-BF-10	Flange-Blind-2527-400-10		515	26	10	565	16X26 mm
DN450-BF-10	Flange-Blind-2527-450-10		565	28	10	615	20X27 mm
DN500-BF-10	Flange-Blind-2527-500-10		620	28	10	670	20X26 mm

UNIVERSAL HD FLANGE GASKET RING - 16 BAR -



FLEN			FOR FLANGE TYPE	
GF16DN015	GASK	F400R-PN16-DN015-RING	DN015	
GF16DN020	GASK	F400R-PN16-DN020-RING	DN020	
GF16DN025	GASK	F400R-PN16-DN025-RING	DN025	
GF16DN032	GASK	F400R-PN16-DN032-RING	DN032	
GF16DN040	GASK	F400R-PN16-DN040-RING	DN040	
GF16DN050	GASK	F400R-PN16-DN050-RING	DN050	
GF16DN065	GASK	F400R-PN16-DN065-RING	DN065	
GF16DN080	GASK	F400R-PN16-DN080-RING	DN080	
GF16DN100	GASK	F400R-PN16-DN100-RING	DN100	
GF16DN125	GASK	F400R-PN16-DN125-RING	DN125	
GF16DN150	GASK	F400R-PN16-DN150-RING	DN150	
GF16DN250	GASK	F400R-PN16-DN250-RING	DN250	
GF16DN300	GASK	F400R-PN16-DN300-RING	DN300	
GF16DN350	GASK	F400R-PN16-DN350-RING	DN350	

UNIVERSAL BOLTS FOR FLANGES - STEEL 8.8 GALVANIZED -



FLEN					L mm
FBOLTM12x50	BOLTS-FLANGE-M12		M12	14	50
FBOLTM16x65	BOLTS-FLANGE-M16		M16	18	65
FBOLTM20x90	BOLTS-FLANGE-M20		M20	22	90
FBOLTM24x90	BOLTS-FLANGE-M24		M24	26 & 27	90

UNIVERSAL NUTS FOR FLANGES - STEEL 8.8 GALVANIZED -

FLEN				
FNUTM12	BOLT-FLANGE-M12		M12	14
FNUTM16	BOLT-FLANGE-M16		M16	18
FNUTM20	BOLT-FLANGE-M20		M20	22
FNUTM24	BOLT-FLANGE-M24		M24	26 & 27

UNIVERSAL WASHERS FOR FLANGES - STEEL 8.8 GALVANIZED -

FLEN				
FWASHERM12	I 3E 3@97-M12		M12	14
FWASHERM16	I 3E 3@97-M16		M16	18
FWASHERM20	I 3E 3@97-M20		M20	22
FWASHERM24	I 3E 3@97-M24		M24	26 & 27

UNIVERSAL SPRING WASHERS FOR FLANGES - STEEL 8.8 GALVANIZED -

FLEN				
FSPRWASM12	FL-SPR-WASHERS-M12		M12	14
FSPRWASM16	FL-SPR-WASHERS-M16		M16	18
FSPRWASM20	FL-SPR-WASHERS-M20		M20	22
FSPRWASM24	FL-SPR-WASHERS-M24		M24	26 & 27

Other versions and materials are available on request